

# Roof Waterproofing Single Layer Covered System

Over LWFC /Screed To Slope/ Accessible Roof

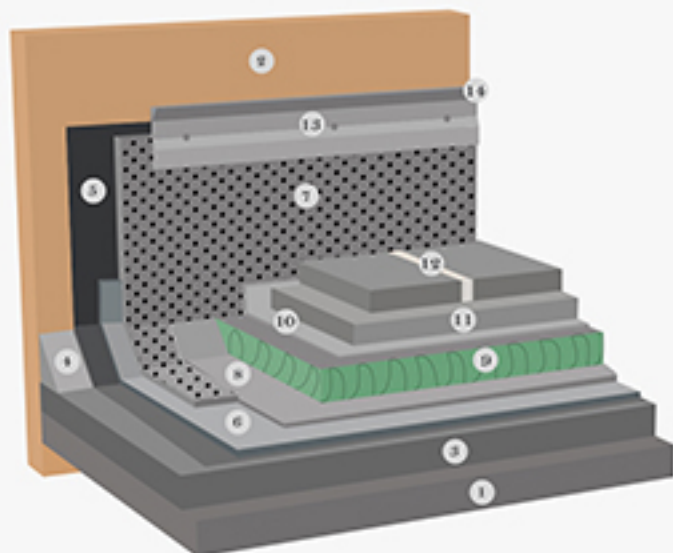

**1 Concrete Roof Deck**

**4 Cant Strip**

**7 Polyflame 4 mm Granule  
Base Flashing**

**10 Bitutex Non Woven  
Geotextile(120 GSM)**

**13 Aluminium Counter  
Flashing**

**2 Parapet Wall**

**5 Concrete Primer**

**8 PE Sheet (150 Mic)**

**11 Mortar Screed**

**14 Sealant**

**3 Screed To Slope**

**6 Polyflame 4 mm Black  
Fully Bonded**

**9 Bitutherm XPS Insulation  
Board**

**12 Tiles With Grout**